

Recommended PCB Layout
(Top View)

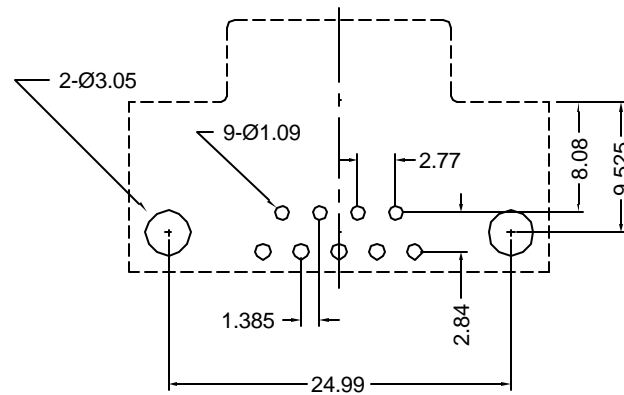

Material and Finish

Shell: steel, tin plated
 Insulator: PBT thermoplastic
 UL 94V-0 rated
 Contact Material: phosphor bronze
 Contact Plating Options:
 Standard: gold flash on mating end, tin on termination end, 50u" nickel underplate on entire contact
 15 Option: 0.000015" gold on mating end, tin on termination end, 50u" nickel underplate on entire contact
 30 Option: 0.000030" gold on mating end, tin on termination end, 50u" nickel underplate on entire contact

Specifications

Rated Current: 5A
 Rated Voltage: 300V DC
 Withstanding Voltage: 500V (r.m.s.) AC for 1 minute
 Insulation Resistance: more than 1000 megohms at 500V DC
 Contact Resistance: 13 milliohm max.
 Dielectric Strength: 1000V for 1 minute
 Operating Temperature: -55°C to +105°C
 Durability Rating: 500 mating cycles min.

Ordering Information	
Part Number	Contact Area Plating Finish
K22X-E9S-N	Gold Flash (standard)
K22X-E9S-N15	15u" Gold (15 option)
K22X-E9S-N30	30u" Gold (30 option)

RoHS COMPLIANT
EU Directive 2002/95/EC



Tolerances
X.X ± 0.25
X.XX ± 0.15
Unless Stated Otherwise

REV.	DATE	DESCRIPTION	REV. BY	CHK. BY	DRAWN BY	DATE
A1	5/6/05	New Drawing	H. MA	C. Furumasu	H. MA	5/6/05

K22X-E9S-Nxx

Rt. Ang. D-Sub, RoHS compliant
9 Pos. female, 0.318" footprint,

